

Compression Connections

BURNDY®

Copper Compression – Code – Two Hole Narrow Tongue – Inspection Window

C-34

TWO HOLE HYLUG™ CODE CONDUCTOR STANDARD BARREL NARROW TONGUE

TYPES YA-L-2NT

COPPER COMPRESSION
TERMINAL

UL Listed 90° C,
600 Volts to 35 kV ◆

45° and 90° angles are available.
Please contact Customer Service to order:
1-800-346-4175

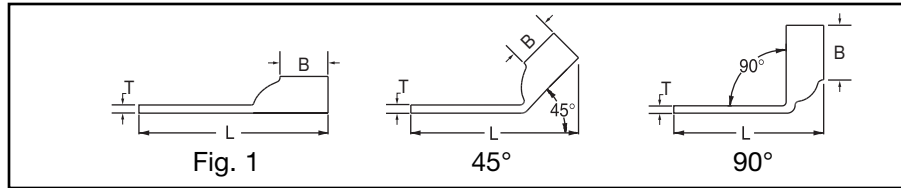
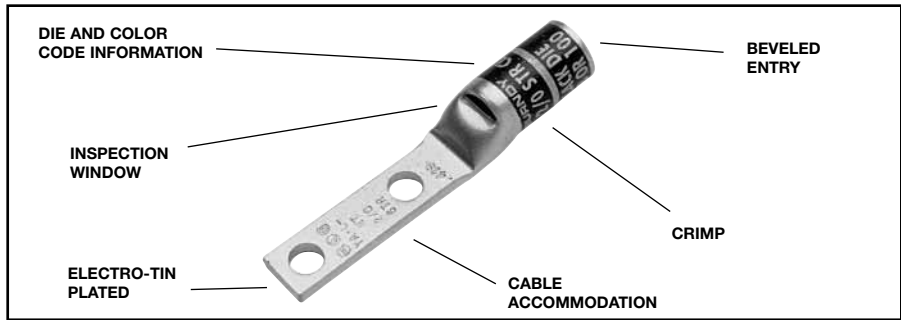

Catalog Number	Fig #	Conductor		Stud Hole Size	Stud Hole Spacing	Tongue Width	Figure Dimensions			Dieless (# of crimps)	▲ Installation Tooling				Wire Strip Length		
		AWG	MM ²				(B)	(T)	(L)		Mechanical		Hydraulic			Color Code	Die Index
											MD6, OUR840, MD7-34R	BCT500HS, Y500CTS	Y35, Y39, Y750, Y46*, PAT750				
YA2CL2NT14	1	#2 AWG	35	1/4"	5/8"	.48"	.88"	.11"	2.47"	W2CVT (1)	W2CVT (1)	U2CRT (1)	Brown	10	15/16"		
YA2CL2NT14E2	1			1/4"	3/4"	.48"	.88"	.11"	2.60"								
YA2CL2NT14E1	1			1/4"	1"	.48"	.88"	.11"	2.84"								
YA1CL2NT14	1	#1 AWG	50	1/4"	5/8"	.50"	.88"	.11"	2.55"	W1CVT (1)	W1CRT (1)	U1CRT (1)	Green	11	15/16"		
YA1CL2NT14E2	1			1/4"	3/4"	.50"	.88"	.10"	2.68"								
YA25L2NT14	1	1/0 AWG	—	1/4"	5/8"	.48"	.88"	.10"	2.56"	W25VT (2)	W25VT (2)	U25RT (1)	Pink	12	15/16"		
YA25L2NT14E1	1			1/4"	1"	.48"	.88"	.12"	3.28"								
YA26L2NT14	1	2/0 AWG	70	1/4"	5/8"	.48"	.94"	.12"	2.66"	W26VT (2)	W26VT (2) X26RT (2)	U26RT (1)	Black	13	1"		
YA26L2NT14E1	1			1/4"	1"	.48"	.94"	.12"	3.03"								

* Use PUADP-1 adapter with U dies in Y46 HYPRESS™.

*** The MM² conductor sizes listed are the recommendations for Class 2 conductor.

Note: All dimensions shown are for reference only.

Blue highlighted items are industry standard and most frequently ordered.

**TWO HOLE HYLUG™
CODE CONDUCTOR
STANDARD BARREL
NARROW TONGUE
(Continued)**

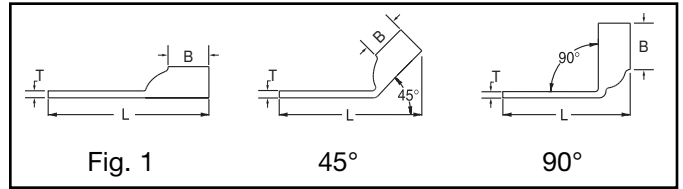

UL Listed 90° C,
600 Volts to 35 kV ◆

45° and 90° angles are available.
Please contact Customer Service to order:
1-800-346-4175



Catalog Number	Fig #	Conductor		Stud Hole Size	Stud Hole Spacing	Tongue Width	Figure Dimensions			▲ Installation Tooling					Wire Strip Length	
		AWG	MM²				(B)	(T)	(L)	Dieless (# of crimps)	Mechanical MD6, OUR840, MD7-34R	Hydraulic		Color Code		Die Index
												Y35, Y39, Y750, Y46*, PAT750				
YA27L2NT14	1	3/0 AWG	—	1/4"	5/8"	.76"	1.00"	.13"	2.73"	MY29-3 (1) MY29-11 (1)	W27VT (2) W27RT (2) X27RT (3)	W27VT (2) W27RT (2) X27RT (3)	U27RT (1)	Orange	14	1-1/16"
YA27L2NT38	1			3/8"	1"	.60"	1.00"	.13"	3.30"	MRC840 (2) Y644HS (1) Y81KFT (1)						
YA27LENT516	1			5/16"	1"	.60"	1.00"	.13"	3.11"	Y81KFTMBH (1) PAT81KFT-18V (1)						
YA28L2NT14	1	4/0 AWG	—	1/4"	5/8"	.76"	.88"	.13"	2.65"	Y81KFTMBH (1) PAT81KFT-18V (1)	W27RT (2)	W28RT (2) X28RT (3)	U28RT (1)	Purple	15	1-1/16"
YA29L2NT38	1	250 kcmil	—	3/8"	1"	.80"	1.00"	.16"	3.43"	MY29-3 (1) MY29-11 (1) Y644HS (1) Y81KFT (1)	W29VT (2) X29RT (2)	W29VT (2) W29RT (2) X29RT (2)	U29RT (1)	Yellow	16	1-1/8"
YA29L2NT38E16	1			3/8"	1-3/4"	.80"	1.06"	.16"	4.18"	Y81KFTMBH (1) PAT81KFT-18V (1)						
YA31L2NT38	1	350 kcmil	185	3/8"	1"	.96"	1.06"	.18"	3.51"	Y644HS (1) Y81KFT (1)	W31VT (2)	W31VT (2) W31RT (2)	U31RT (2) U29ART (2)	Red	18	1-1/8"
YA31L2NT38E16	1			3/8"	1-3/4"	.88"	1.06"	.18"	4.26"							
YA34L2NT38	1	500 kcmil	240	3/8"	1"	.96"	1.27"	.23"	3.65"	Y644HS (1) Y81KFT (1)	W34VT (4)	W34VT (4)	U34RT (2)	Brown	20 or 22	1-7/16"
YA34L2NT38E16	1			3/8"	1-3/4"	.96"	1.27"	.23"	4.63"							
YA34L2NTE1	1			1/2"	1"	.96"	1.27"	.23"	4.13"							
YA36L2NNT	1	600 kcmil	300	1/2"	1-3/4"	1.12"	1.38"	.27"	5.43"	Y81KFTMBH (1) PAT81KFT-18V (1)	—	—	U36RT (2)	Green	472	1-3/4"
YA39L2NT38	1	750 kcmil	—	3/8"	1"	1.63"	1.42"	.27"	4.34"	Y81KFTMBH (1) PAT81KFT-18V (1)	—	—	U39RT (2)	Black	24	1-1/2"
YA39L2NT38E16	1			3/8"	1-3/4"	1.30"	1.42"	.27"	5.11"							
YA39L2NT12E1	1			1/2"	1"	1.30"	1.42"	.27"	4.42"							

* Use PUADP-1 adapter with U dies in Y46 HYPRESS™.

*** The MM² conductor sizes listed are the recommendations for Class 2 conductor.

Note: All dimensions shown are for reference only.